

OPTIMUS CRUX - extremely compact-gas canister stove

PRODUCT CHARACTERISTICS

Gas:	Butane/isobutane/propane
Ø Burn time:	90 minutes max at full power (230 g gas cartridge)
Ø Boil time:	3 minutes approx. for 1 L water
Output:	3'000 Watt / 10'200 BTU/h
Weight:	83 g / 2.9 oz
Dimensions:	76 x 57 x 34 mm / 3.0 x 2.2 x 1.3 in (open) 84 x 57 x 34 mm / 3.3 x 2.2 x 1.3 in (folded)
Guarantee:	2 years
Material:	Stainless steel, aluminum
Accessories:	strap-on stuff bag
Article No.:	8019260 Optimus Crux



FACTS

- Extremely compact stove
- Minimum packing dimensions thanks to folding burner head
- The only stove that can be stowed in a space-saving way in the cavity of the gas cartridge
- Powerful and stable 3000 W burner
- Large burner head for optimal heat distribution
- Precise flame control – simmering without burning
- Pot support inner arms double as windshield

OPTIMUS CRUX - extremely compact-gas canister stove

EXPLODED VIEW

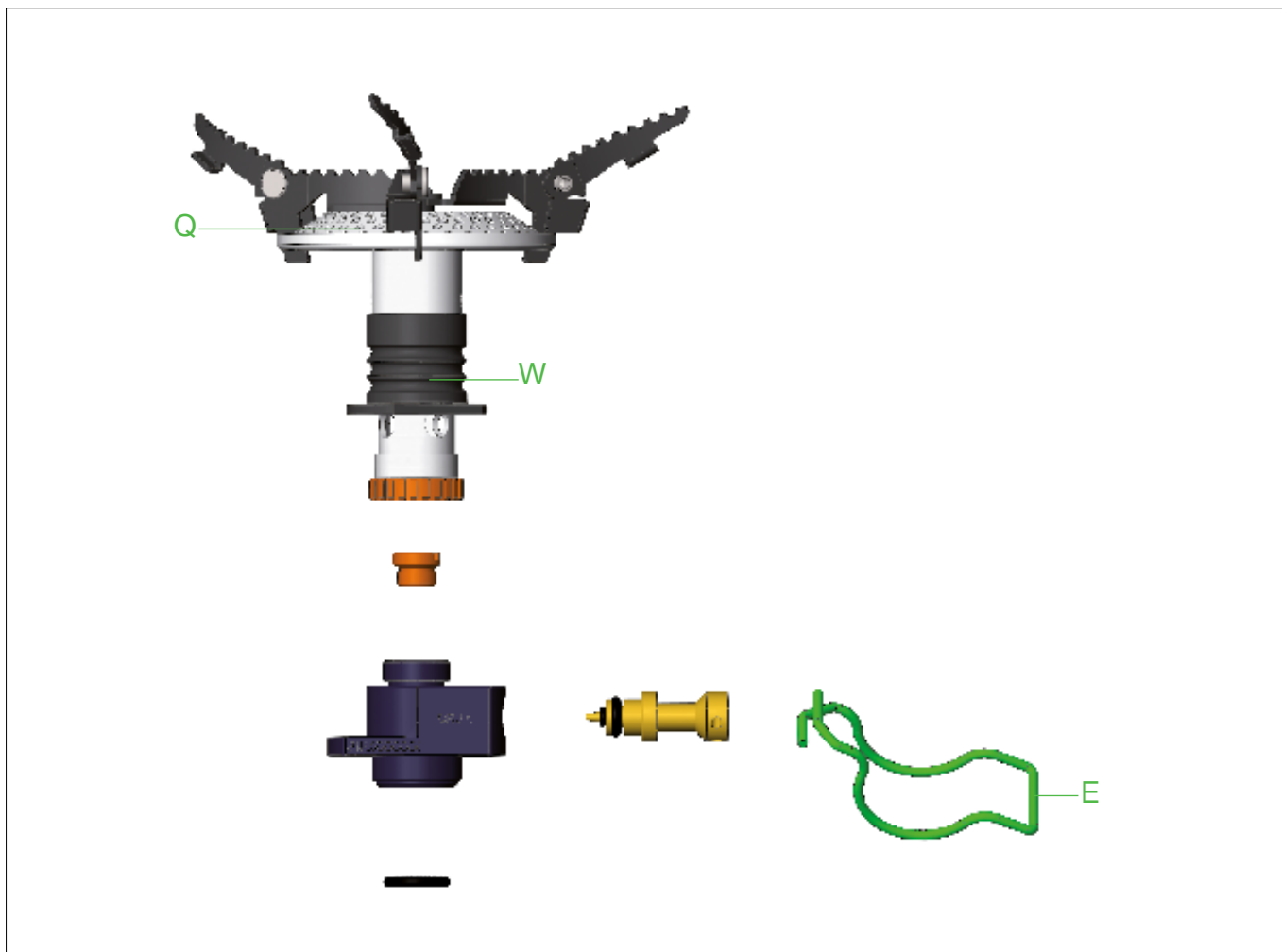

- Q Burner head
- W Latch sleeve
- E Control handle

Katadyn reserves the right to modify product characteristics
Version: 23.09.2021

Katadyn Products Inc. | Pfäffikerstrasse 37 | 8310 Kemptthal | Switzerland
Tel: +41 44 839 21 11 Fax: +41 44 839 21 99
info@katadyn.ch | www.optimusstoves.com