

## OPTIMUS CRUX WEEKEND HE COOK SYSTEM

### PRODUCT CHARACTERISTICS

Gas:	Butane/propane
ø Burning time:	Up to 90 minutes at full output (220 g gas cartridge)
ø Cooking time:	For 1 l water approx. 3 minutes
Output:	Watt: 3000 BTU: 10'200
Weight:	358 g
Volume:	0.95 L
Dimensions:	124 x 165 mm
Guarantee:	2 years
Material:	Burner: stainless steel, aluminum Pots: hardanodized aluminum
Content:	Crux gas stove, 0.95 L saucepan with pouring lip and measuring marks, fry pan (lid), mesh storage bag and neoprene sleeve for Crux
Article No.:	8019743 Optimus Crux Weekend HE Cook System



### PRODUCT CHARACTERISTICS > BENEFITS

- Efficient 3-piece cooking system consisting of Optimus Crux gas stove and the Terra Weekend HE Cook Set
- Powerful and stable 3000 W burner
- Large burner head for optimal heat distribution
- Precise flame control – simmering without burning
- Non-stick coated Terra Weekend HE Cook Set of hard-anodized aluminum
- The special Heat Exchanger on the bottom of the saucepan reduces energy consumption and saves fuel when cooking
- Offers perfect space for a 230 g gas cartridge and a folding spork

## OPTIMUS CRUX WEEKEND HE COOK SYSTEM

### EXPLODED VIEW OPTIMUS CRUX

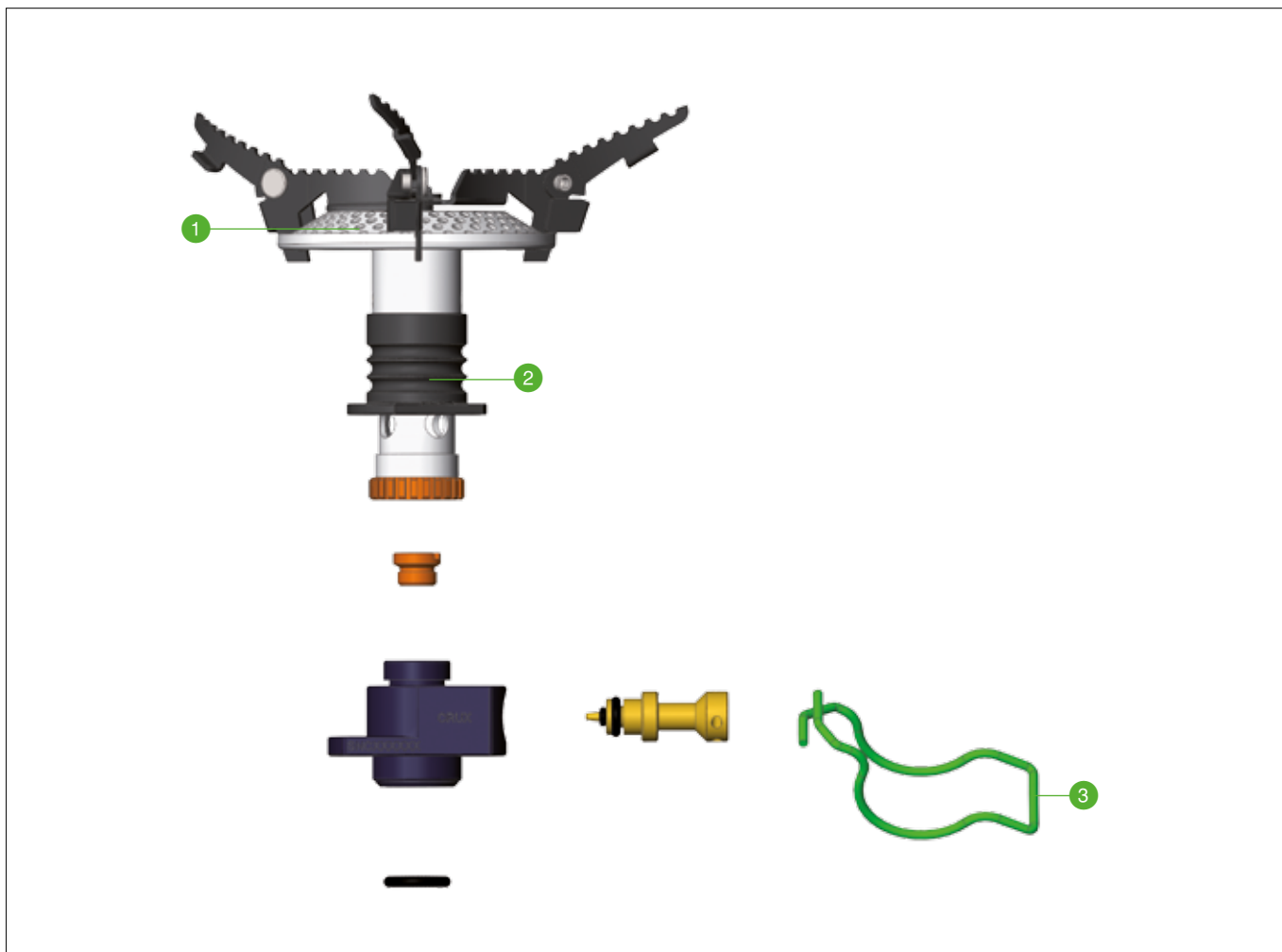

- 1 Burner head
- 2 Latch sleeve
- 3 Control handle

Katadyn reserves the right to modify product characteristics